

Approved Medina Tree Activity Permit Plan

05/10/2023

Andy Crossett

Medina Tree Consultant

501 MEDINA, WA 98039
PHONE: 425-233-4414/4400

DEVELOPMENT SERVICES

ADMINISTRATIVE TREE ACTIVITY WORKSHEET

T-01

Complete this form for the following:

- The property is designated as under development regardless of whether a tree is removed (MMC 16.52.060)
- Removal of any significant tree on private property having a 6-inch DBH and larger size, but less than 36 inches DBH
- Removal of any non-significant tree on private property within 200 feet of the shoreline having a 6-inch DBH and larger size
- Removal of a hazard tree from a city right-of-way

<input checked="" type="checkbox"/> New Application <input type="checkbox"/> Supplemental	Staff Only	Date Received:	By:	Permit No. TREE-23-023
--	------------	----------------	-----	----------------------------------

Property Information	
Property Address: 3220 78TH PL NE MEDINA WA 98039	Check if tree is located: <input type="checkbox"/> Within 200 feet of shoreline <input type="checkbox"/> Within a critical area (Ch. 16.50 / 16.67 MMC)
Tax Parcel No. 7397300170	

Legal Property Owner Information				
Name: Yue Li				Email: dykd2004@163.com
Mailing Address: 3220 78TH PL NE	City: MEDINA	State: WA	Zip: 98039	Phone: 425-625-9768

Contact/ Agent Information	
Name: Yue Li	Email: dykd2004@163.com
Address: 3220 78TH PL NE MEDINA WA 98039	Phone: 425-625-9768

Contractor Information	Email & Phone:
-------------------------------	----------------

Project Information	
Is the lot under development? <input type="checkbox"/> Yes <input checked="" type="checkbox"/> No	<input checked="" type="checkbox"/> Application is for tree performance standards (attach form T-01a)
Does the lot meet the tree retention requirements of MMC 16.52.090? <input type="checkbox"/> Yes <input checked="" type="checkbox"/> No	Check One: <input type="checkbox"/> Application is for tree restoration standards (attach form T-01b)

Application Submittal Checklist				
The following materials are required for a complete application:				
Copies	Material to be submitted	Applicant	N/A	City
2	This form completed.....	<input checked="" type="checkbox"/>	<input type="checkbox"/>	<input type="checkbox"/>
1	Proof of ownership.....	<input checked="" type="checkbox"/>	<input type="checkbox"/>	<input type="checkbox"/>
1	Declaration of Agency.....	<input type="checkbox"/>	<input type="checkbox"/>	<input type="checkbox"/>
2	Completed T-01a form if performance standards apply (See MMC 16.52.090).....	<input checked="" type="checkbox"/>	<input type="checkbox"/>	<input type="checkbox"/>
2	Completed T-01b form if restoration standards apply (See MMC 16.52.110).....	<input type="checkbox"/>	<input checked="" type="checkbox"/>	<input type="checkbox"/>
2	Tree removal and planting plan (required for tree performance standards).....	<input checked="" type="checkbox"/>	<input type="checkbox"/>	<input type="checkbox"/>
2	Tree protection measures (required for properties under development).....	<input type="checkbox"/>	<input checked="" type="checkbox"/>	<input type="checkbox"/>
1	Critical Areas Report (if applicable).....	<input type="checkbox"/>	<input checked="" type="checkbox"/>	<input type="checkbox"/>
1	City Hazard Tree Assessment (if applicable).....	<input type="checkbox"/>	<input checked="" type="checkbox"/>	<input type="checkbox"/>

I declare under penalty of perjury that I am the owner of the above property or the duly authorized agent of the owner(s) and that all applicable information furnished in support of this application is true, correct and complete.

Print Name: Yue Li Owner Agent (check one)

Signature: *Yue Li* Date: 5/8/2023

City Use Only		
Application Fee:	<input type="checkbox"/> Check if issued same day as submittal	Planning Approval: / /
Tech Fee:		Tree Approval: / /
Advanced Deposit:		Final Inspection: / /



501 EVERGREEN POINT ROAD MEDINA, WA 98039
PHONE: 425-233-6414/6400

Instructions: Complete and attach this form to T-01 for the following:

- The property is designated as under development pursuant to MMC 16.52.060
- The applicant is using the tree performance standards in MMC 16.52.090

File No.

- New
 Revision

STEP 1: Inventory existing tree units Conduct an inventory of all significant trees within the boundaries of the lot.

No.	Tree	DBH	No.	Tree	DBH
1	Fir Tree	21"	7	Fir Tree	21"
2	Fir Tree	14"	8	Fir Tree	17"
3	Fir Tree	13"	9	Fir Tree	18"
4	Fir Tree	21"	10	Fir Tree	7"
5	Fir Tree	23"	11	Fir Tree	5"
6	Fir Tree	16"	12	Fir Tree	7"

STEP 2: Calculate Existing Tree Units From Table 16.52.090(C): add together the number of significant trees in each range below and multiply by the corresponding value to produce Existing Tree Units.

A.	Total number of trees at least 6 inches, but less than 10 inches DBH	5	X 0.50 =	2.50	D. TOTAL EXISTING TREE UNITS (A + B + C) 15.25
B.	Total number of trees 10 inches DBH and larger	17	X 0.75 =	12.75	
C.	Total number of conifer trees 36 inches DBH and larger	0	X 1.00 =	0	

STEP 3: Inventory removed trees List the significant trees that are proposed for removal. This information will be used in Step 4 and 7 (if applicable).

No.	Tree	DBH	No.	Tree	DBH
1	Fir Tree	21"			
2	Fir Tree	21"			

STEP 4: Calculate Net Existing Tree Units To calculate Net Existing Tree Units, add together the number of significant trees in each range below that are proposed for removal and multiply by the corresponding value. Then follow H and I.

E.	Total number of trees removed at least 6 inches, but less than 10 inches DBH	0	X 0.50 =	0	H. TOTAL TREE UNITS TO BE REMOVED (E + F + G) 1.50
F.	Total number of trees removed 10 inches DBH and larger	2	X 0.75 =	1.50	
G.	Total number of conifer trees 36 inches DBH and larger	0	X 1.00 =	0	I. Net Existing Tree Units (subtract H from D) 13.75

STEP 5: Calculate Required Tree Units To calculate Required Tree Units, perform the calculations in J through M.

J.	Lot Area (sq. ft.)	5550	K.	Divide J by 1,000	5.55	L.	Tree Density Ratio (check one)	M. REQUIRED TREE UNITS (Multiply K x L) 2
							<input checked="" type="checkbox"/> 0.40 (residential) <input type="checkbox"/> Table 16.52.090(B)	

STEP 6: Determine if Supplemental Trees are required Subtract the Tree Units in M from the Tree Units in I.
 • If the difference is zero or a positive number - stop. No supplemental trees are required.
 • If the difference is a negative number then go to Step 7.

See Page 2 for Step 7 and for additional inventory tables

- STEP 7: Calculate Supplemental Trees**
- Each replacement of a 24-inch DBH and larger tree requires two supplemental trees with each supplemental tree having a Tree Unit value = 0.5.
 - Each replacement of a less than 24-inch DBH tree & each tree that fills a gap requires one supplemental tree with each supplemental tree having a Tree Unit value = 1.0
 - Each replacement of a Legacy or Landmark tree requires mitigation pursuant to MMC 16.52.080. The total mitigation for each Legacy or Landmark tree has a Tree Unit value = 1.0
 - The total Tree Units of the supplemental trees must equal or be greater than the absolute value of N.
 - Tree Units are assigned first to those supplement trees replacing removed trees and in order of largest to smallest tree.

For replacement of 24-inch DBH and larger tree					For replacement of less than 24-inch DBH/ Fill Existing Gap trees				
No.	Check if Applied	# of Supp. Trees	Proposed # Supp. Trees	Tree Unit	No.	Check if Applied	# of Supp. Trees	Proposed # Supp. Trees	Tree Unit
	<input type="checkbox"/>	2				<input type="checkbox"/>	1		
	<input type="checkbox"/>	2				<input type="checkbox"/>	1		
	<input type="checkbox"/>	2				<input type="checkbox"/>	1		
	<input type="checkbox"/>	2				<input type="checkbox"/>	1		
	<input type="checkbox"/>	2				<input type="checkbox"/>	1		
	<input type="checkbox"/>	2				<input type="checkbox"/>	1		
	<input type="checkbox"/>	2				<input type="checkbox"/>	1		
	<input type="checkbox"/>	2				<input type="checkbox"/>	1		
	<input type="checkbox"/>	2				<input type="checkbox"/>	1		
	<input type="checkbox"/>	2				<input type="checkbox"/>	1		
	<input type="checkbox"/>	2				<input type="checkbox"/>	1		
	<input type="checkbox"/>	2				<input type="checkbox"/>	1		
	<input type="checkbox"/>	Legacy or Landmark Tree				<input type="checkbox"/>	1		
	<input type="checkbox"/>	Legacy or Landmark Tree				<input type="checkbox"/>	1		
O.	Total				P.	Total			
								Total from O	
<ul style="list-style-type: none"> • Q is the number of supplemental trees required to be planted. • The Tree Units in R must equal or be greater than the Tree Units in N. 								Grand Totals	Q. R.

STEP 1: Inventory existing tree units

No.	Tree	DBH	No.	Tree	DBH
13	Fir Tree	5"	21	Fir Tree	17"
14	Fir Tree	4"	22	Fir Tree	23"
15	Fir Tree	7"	23	Maple Tree	9"
16	Fir Tree	13"	24	Maple Tree	9"
17	Fir Tree	17"	25	Fir Tree	23"
18	Fir Tree	14"	26		
19	Fir Tree	16"	27		
20	Fir Tree	15"	28		

STEP 3: Inventory removed trees

No.	Tree	DBH	No.	Tree	DBH

Attach additional sheets if needed.

Applicant Name:

Yue Li

Street Address:

3220 78TH PL NE MEDINA WA 98039

Parcel ID Number:

7397300170

Tree Description Table

All Significant Trees on Property	Remove?	Diameter in Inches at Breast Height
1. Fir Tree	Remove	21"
2. Fir Tree	No	14"
3. Fir Tree	No	13"
4. Fir Tree	Remove	21"
5. Fir Tree	No	23"
6. Fir Tree	No	14"
7. Fir Tree	No	21"
8. Fir Tree	No	17"
9. Fir Tree	No	18"
10. Fir Tree	No	7"
11. Fir Tree	No	5"
12. Fir Tree	No	7"
13. Fir Tree	No	5"
14. Fir Tree	No	4"
15. Fir Tree	No	7"
16. Fir Tree	No	13"
17. Fir Tree	No	17"
18. Fir Tree	No	14"
19. Fir Tree	No	14"
20. Fir Tree	No	15"
21. Fir Tree	No	17"
22. Fir Tree	No	23"
23. MapleTree	No	9"
24. MapleTree	No	9"
25. Fir Tree	No	23"

78TH PL NE

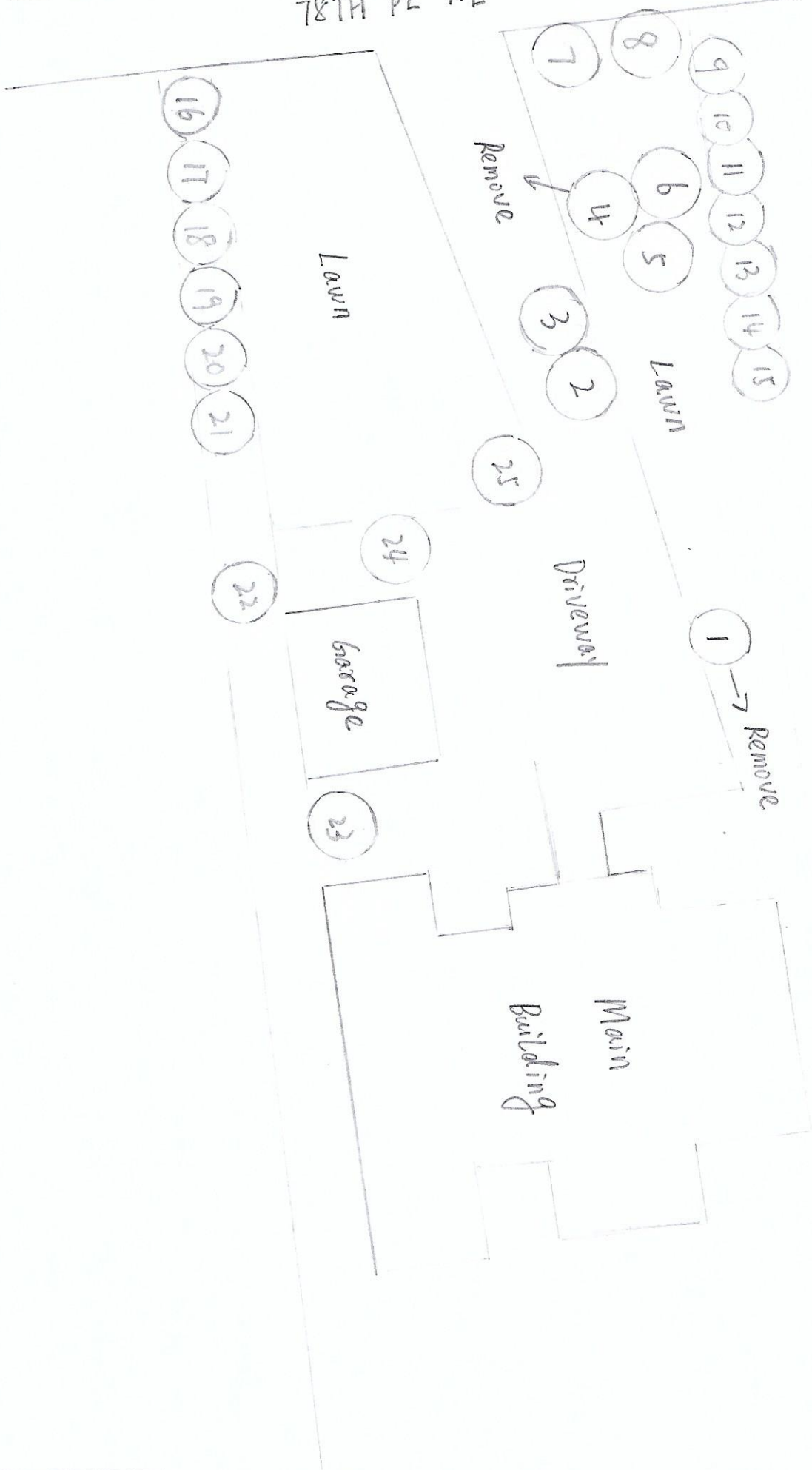



1600 127th Ave NE
 Bellevue WA 98005-213636
Customer Service (800) 221-4508
 RepublicServices.com/Support

Account Number 3-0172-0114124
Invoice Number 0172-009162568
Invoice Date February 28, 2023
Previous Balance \$130.05
Payments/Adjustments -\$130.05
Current Invoice Charges \$133.11

Important Information

Current charges on this invoice become delinquent after 04/30/23. A late fee of 1%(minimum of \$1.00) may be assessed at that time. To avoid service interruption pay any previous balance shown above.

Total Amount Due \$133.11	Payment Due Date March 18, 2023
-------------------------------------	---

PAYMENTS/ADJUSTMENTS

Description	Reference	Amount
Payment - Thank You 12/19	1	-\$130.05

CURRENT INVOICE CHARGES

Description	Reference	Quantity	Unit Price	Amount
Li Yue 3220 78th PI NE				
Medina, WA Contract: 6130008 (C3)				
1 Trash Can 32 Gal, 1 Lift Per Week				
Hazardous Waste Fee 02/01-04/30			\$3.12	\$3.12
*1 Can Service 01/01-01/31		1.0000	\$45.54	\$69.00
*1 Can Service 02/01-04/30			\$45.54	\$45.54
1 Recycle Cart 90 Gal, 1 Lift Per 2 Weeks				
Recycling Service 02/01-04/30			\$31.62	\$31.62
Value Of Recyclables Sold 02/01-04/30			-\$3.90	-\$3.90
2 Yard Waste Cart 90 Gal, 2 Lifts Per 2 Weeks				
Rent/Yardwaste Cart 02/01-04/30		2.0000	\$6.12	\$12.24
90 Gallon Yardwaste Service 02/01-04/30			\$32.79	\$32.79
Total City Utility Tax				\$7.80
Total City Sales Tax				\$0.47
Total State Sales Tax				\$0.85
Total State Refuse Tax				\$1.89
CURRENT INVOICE CHARGES				\$133.11



1600 127th Ave NE
 Bellevue WA 98005-213636

Thank You For Choosing Paperless

Total Enclosed

Address Service Requested

LI, YUE
 3220 78TH PL NE
 MEDINA WA 98039-1004

Total Amount Due	\$133.11
Payment Due Date	March 18, 2023
Account Number	3-0172-0114124
Invoice Number	0172-009162568

For Billing Address Changes,
 Check Box and Complete Reverse.

Make Checks Payable To:

REPUBLIC SERVICES #172
 FOR RABANCO, LTD
 PO BOX 78829
 PHOENIX AZ 85062-8829



UNDERSTANDING YOUR BILL

Visit RepublicServices.com/MyBill

Check Processing

When you provide a check as payment, you authorize us to use information from your check to make a one-time electronic fund transfer from your account. When we make an electronic transfer, funds may be withdrawn from your account the same day we receive your payment or check and you will not receive your check back from your financial institution.

Cancellation & Payment Policy

Unless prohibited by applicable law, regulation, or franchise or other agreement: (1) we reserve the right to require that payment for services be made only by check, credit card or money order; and (2) if service is canceled during a billing cycle, you will remain responsible for all charges, fees and taxes through the end of the billing cycle. You will not be entitled to proration of billing or a refund for the period between the notice of termination and the end of the current billing cycle.

Understanding Our Rates, Charges and Fees

If you are receiving service from Republic Services without a written contract, please visit RepublicServices.com/Fees to review the financial terms and conditions relating to your service. If you are receiving service from Republic Services pursuant to a written contract, but have questions relating to any charges or fees, RepublicServices.com/Fees provides a detailed description of Republic Services most common charges and fees. If you do not have access to a computer, you may request that a copy be mailed to you by calling Customer Service at the number on the front of this invoice.

IMPORTANT INFORMATION

(Continued from Page 1)

Rates increased effective January 1st, 2023 due to the King County Solid Waste Fee increase.

Simple account access at your fingertips.

Download the Republic Services app or visit RepublicServices.com today.



Please fill out the form below if your billing address has changed and return this portion of your statement to us using the envelope enclosed. Thank you!

BILLING ADDRESS CHANGE

Address		
City	State	Zip Code
Phone	Alternate Phone	